

Type of shaft: 軸的型式

R1210N
R1210G

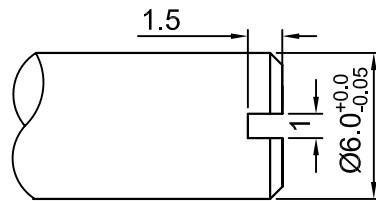
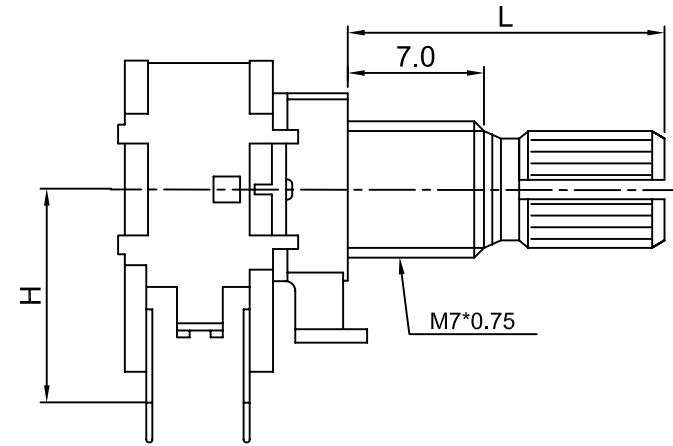
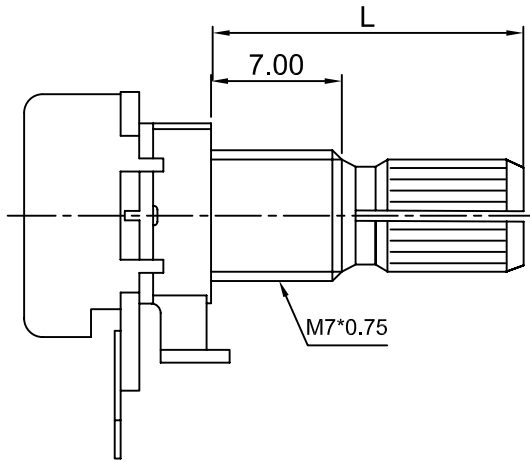

S TYPE:

X	Q	R	S	
L	15	20	25	

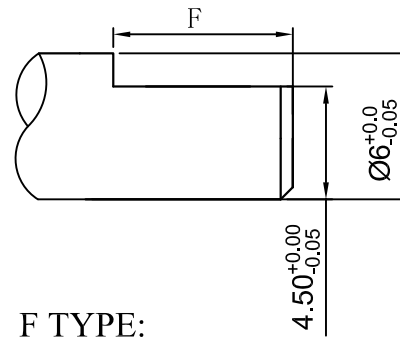

F TYPE:

X	A	B	C	D
L	15	20	25	30
F	7	12	12	14

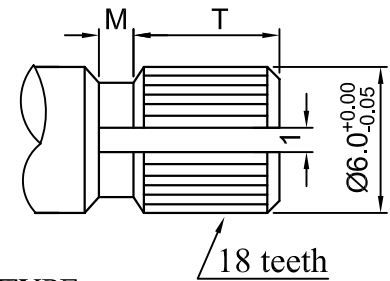

KQ TYPE:

X	2	3	4	5	
L	15	20	25	30	
T	6	8	12	12	
M	1	2	2	2	

電氣的性能 :Electrical Characteristics

全阻抗值 (Total Resistance)	1KΩ~1MΩ
全阻抗值允许偏差 (Total Resistance Tolerance)	±20%(more than 1MΩ±30%)
阻值變化特性 (Resistance Taper)	A、B、C
残留阻值 (Residual Resistance)	R ≥ 250KΩ 0.1% max.of total resistance 10KΩ < R < 250KΩ 20Ω max. R ≤ 10KΩ 10Ω max.
額定功率 (Rated Power)	B: 0.08W other than B:0.04W (B以外)
最高使用電壓 /Max	B:150V AC Other than B:100V AC (B以外)
耐電壓 (Withstand Voltage)	For 1minute or more at 250V AC
絕緣阻抗 (Insulation Resistance)	more than 50MΩ at DC 500V
相互偏差 (Gang Error)	-40 ~ 0 dB ≤ 3dB(雙聯)

機械的性能:Mechanical Characteristics

全回轉角度 (Rotation Angle)	300°±10°
旋轉力矩 (Rotation Torque)	2~20mN.m (20~204gf.cm)
軸的拉、押強度 (Pull-Push Strength)	70N (7kgf) max.
轉動止檔強度 (Rotational Stop-End Torque)	0.5N.m(5kgf.cm)
C.C.扭力(Click torque)	5~30mN.m(50~300gf.cm)

耐久的性能 (Durability)

回轉壽命 (Rotational Life)	15,000 cycles
------------------------	---------------