

# 外形图 Mechanical Dimensions

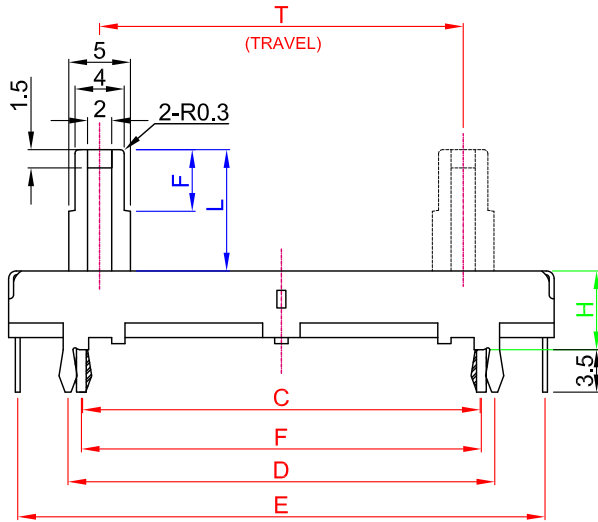

Height(Y)

	<input type="checkbox"/>	<input type="checkbox"/>
Y	1	2
H	6.5	8.0

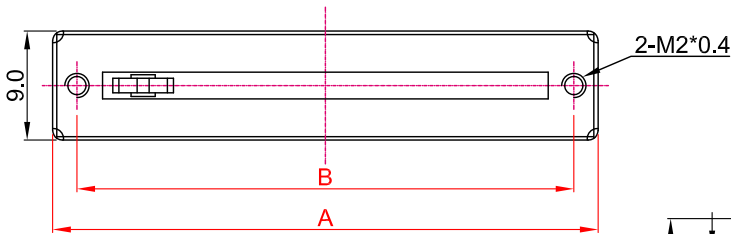
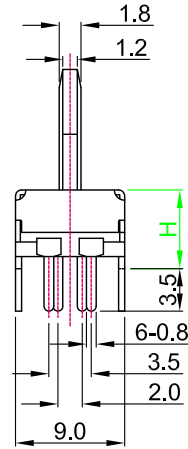

安装孔位图  
P.C.B. mounting hole detail

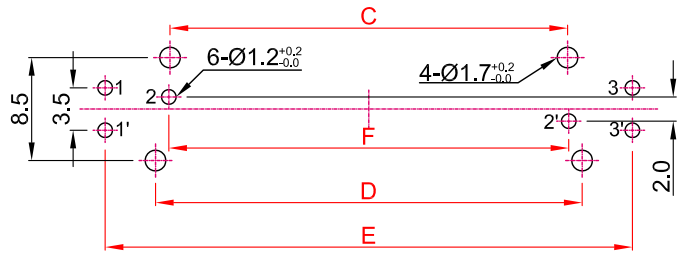

C型塑胶推柄 (C type Insulated Lever)

	<input type="checkbox"/>	<input type="checkbox"/>	<input type="checkbox"/>	<input type="checkbox"/>	<input type="checkbox"/>	<input type="checkbox"/>
X	1	2	3	5	6	7
L	10	12.5	15	18	20	25
F	5	5	5	5	5	5

接线图

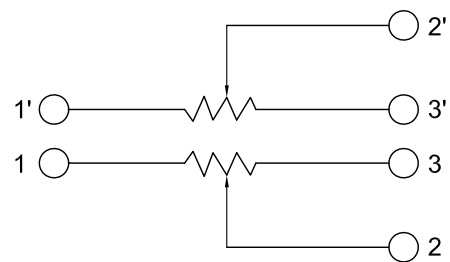

Circuit explanation



	MODEL NO.	T	A	B	C	D	E	F	G
<input type="checkbox"/>	C1521G	15	30	26	17.8	20.2	28.5	18	
<input checked="" type="checkbox"/>	C2021G	20	35	31	22.8	25.2	33.5	23	
<input type="checkbox"/>	C3021G	30	45	41	32.8	35.2	43.5	33	
<input type="checkbox"/>	C4521G	45	60	56	47.8	50.2	58.5	48	
<input type="checkbox"/>	C6021G	60	75	71	62.8	65.2	73.5	63	
<input type="checkbox"/>	C0021G	100	117	112.5	104.6	107	115.2		20

<input type="checkbox"/>				PRODUCT NAME	Slide Potentiometer		
<input type="checkbox"/>				MODEL NAME	C <input type="checkbox"/> <input type="checkbox"/> <input type="checkbox"/> 21G - <input type="checkbox"/> A <input type="checkbox"/> -value		
NO	DATE	DESCRIPTION		APPROVED BY	CHECKED BY	DRAWN BY	
		DIMENSION	TOLERANCE	SCALE			
		$\int \leq 10$	$\pm 0.2$	UNIT			mm
		$10 < \int \leq 30$	$\pm 0.5$	VER.			A0
		$30 < \int \leq 100$	$\pm 1.0$	DATE			2018/4/28
		All Angles	$\pm 5^\circ$				

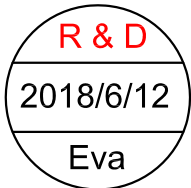
# 直滑式 Rotary Potentiometers series Specifications

1. 電氣性能 (Electrical Characteristics)								
1.1	全阻抗值 (Total Resistance)	1KΩ ~ 2MΩ						
1.2	全阻抗值允許偏差 (Total Resistance Tolerance)	±20% ( More than 1 M Ω ±30%)						
1.3	電阻隨溫度變化特性 Resistance of temperature change character	20°C-75°C:ΔR/R≤±5%, -25°C-20°C:ΔR/R≤±4.5%						
1.4	阻值變化特性 (Resistance Taper)	A, B, C, W						
1.5	零位阻值 (Residual Resistance)	R≥250KΩ / 0.1 % max. of total Value 250KΩ>R>10KΩ / 20Ω max. 10KΩ≥R / 10Ω max.						
1.6	額定功率 (Rated Power)	TAPER	TRAVEL					
			15mm	20mm	30mm	45mm	60mm	100mm
		Linear B:	0.025W	0.05W	0.1W	0.125W	0.125W	0.125W
	Other	0.012W	0.025W	0.05W	0.06W	0.06W	0.06W	
1.7	最高使用電壓 (Max.Operating Voltage)	50V AC						
1.8	動雜音 (Rotational Noise)	Less Than 100mV						
1.9	絕緣阻抗 (Insulation Resistance)	More than 100MΩ at DC 250V						
1.10	耐電壓 (Withstand Voltage)	For 1 minute at: AC 300V						
1.11	开关额定功率(Switch Rated Power)	-----						
1.12	同步誤差 (Gang Error)	0dB~-40dB ≤3dB						
2. 機械性能 (Mechanical Characteristics)								
2.1	滑动行程 (Slide travel)	T=(15,20,30,45,60)±1.0mm						
2.2	滑动力矩 (Operating force)	10~200gf.cm						
2.3	柄的拉、押強度 (Pull-Push Strength)	Pull 3Kgf.cm / Push 5 Kgf.cm						
2.4	滑动止檔強度 (Rotational Stop-End Torque)	5 kgf.cm Min						
2.5	推柄摆动度 (Lever wobble)	2xL/25mm Max. (L=Lever length)						
2.6	旋轉定位數目 (Number of Detents(click))	detent: 0 ; 1 centre Click						
2.7	焊錫耐熱性 (Resistance To Soldering Heat)	260±5°C and less than 3 seconds						
3. 耐久性能 (Durability)								
3.1	回轉壽命 (Rotation Life)	10,000 Cycles min.						
3.2	工作溫度 (Operating temperature)	-10°C ~ +70°C						
4.1	外形尺寸圖/曲線特性圖	見附頁						
	(Shape size drawing/curve characteristic drawing)	Please refer the drawing						
批 准		審 核		設 計				

# RESISTANCE TAPER



### TAPER B SERIES

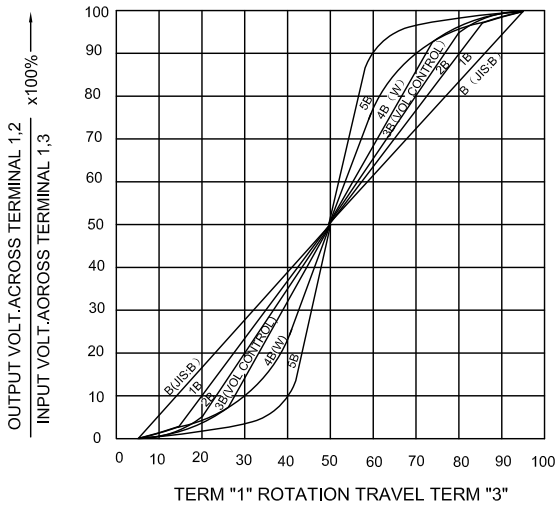

### TAPER B WITH 50% TAP

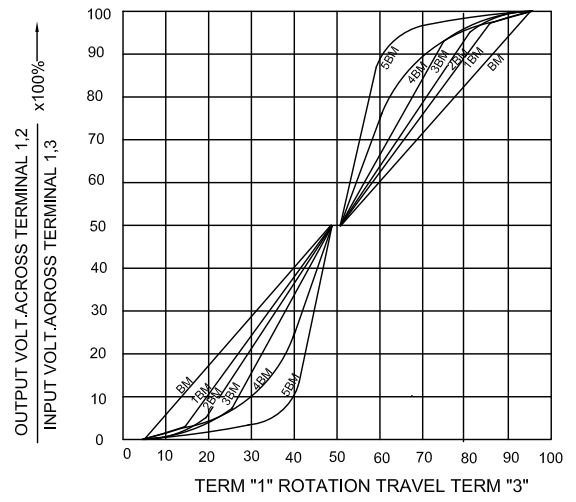

### TAPER A SERIES

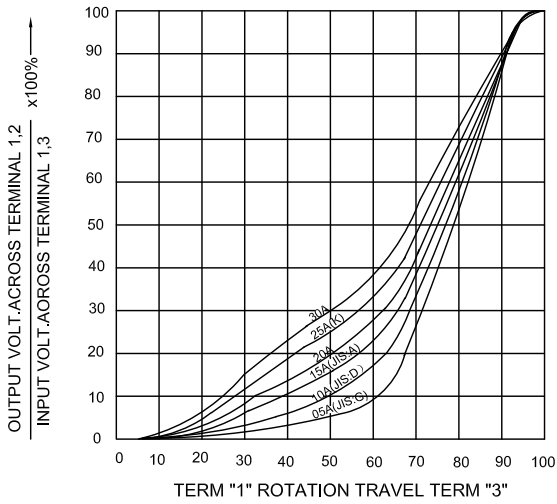

### TAPER A & C WITH 50% TAP

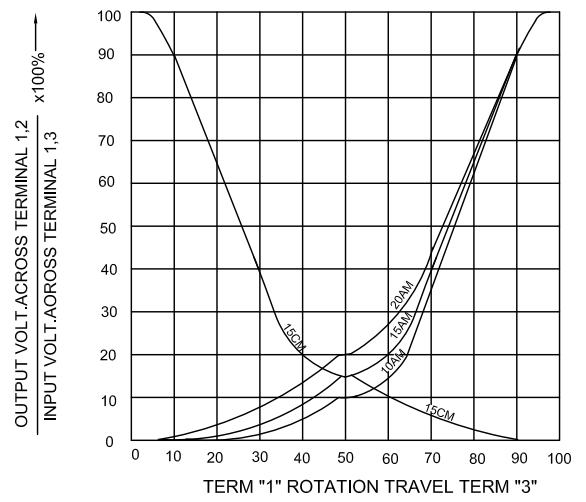

### TAPER C SERIES

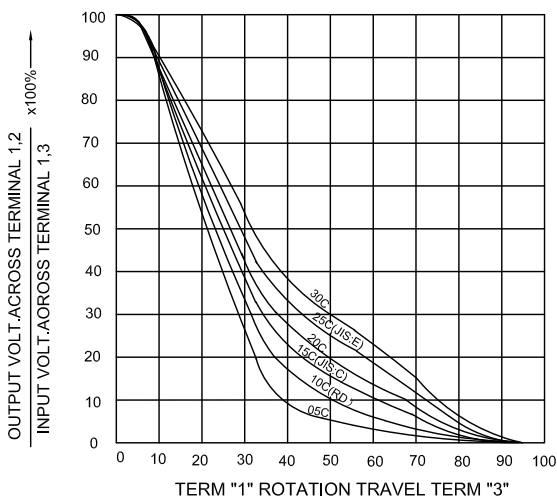

### TAPER M & N SERIES

