

# 外形图 Mechanical Dimensions

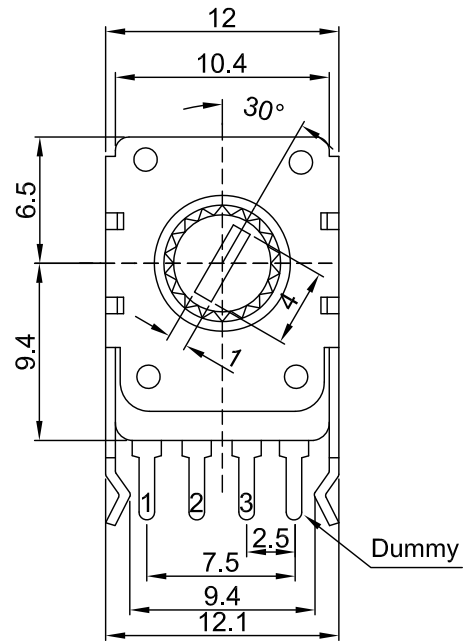

Shaft shown in full C.C.W. position

接线图  
Circuit explanation

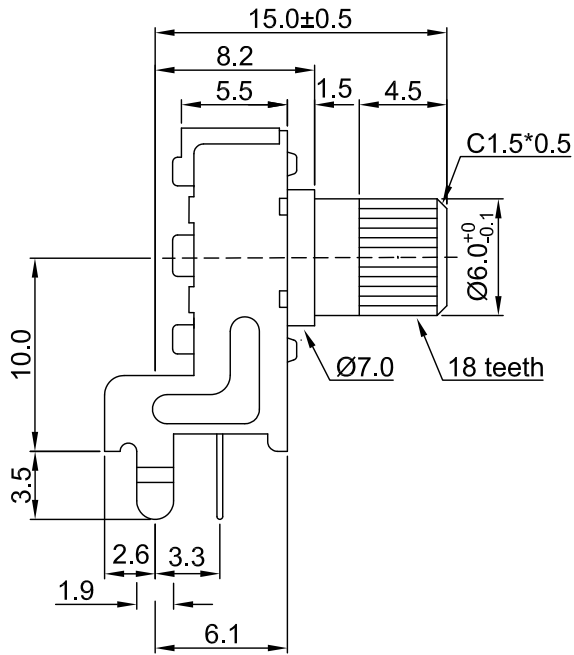
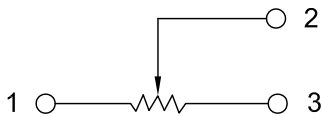

安装孔位置图  
P.C.B. mounting hole detail

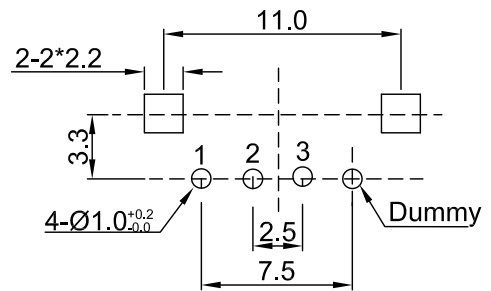

3				PRODUCT NAME	Rotary Potentiometer	
2				MODEL NAME	R1116N-PA1-value	
1				APPROVED BY	CHECKED BY	DRAWN BY
NO	DATE	DESCRIPTION				
DIMENSION	TOLERANCE	SCALE				
$\int \leq 10$	$\pm 0.2$	UNIT	mm	<div style="border: 1px solid black; border-radius: 50%; padding: 5px; width: 60px; margin: 0 auto;"> <div style="text-align: center; color: red; font-weight: bold;">R &amp; D</div> <div style="text-align: center;">2014/9/1</div> <div style="text-align: center;">Eva</div> </div>	<div style="border: 1px solid black; border-radius: 50%; padding: 5px; width: 60px; margin: 0 auto;"> <div style="text-align: center; color: red; font-weight: bold;">R &amp; D</div> <div style="text-align: center;">2014/9/1</div> <div style="text-align: center;">Sophie</div> </div>	<div style="border: 1px solid black; border-radius: 50%; padding: 5px; width: 60px; margin: 0 auto;"> <div style="text-align: center; color: red; font-weight: bold;">R &amp; D</div> <div style="text-align: center;">2014/9/1</div> <div style="text-align: center;">Ball</div> </div>
$10 < \int \leq 30$	$\pm 0.5$	VER.	A0			
$30 < \int \leq 100$	$\pm 1.0$	DATE	2014/9/1			
All Angles	$\pm 5^\circ$					

# 11 mm Rotary Potentiometers series Specifications

1.電氣性能 (Electrical Characteristics)					
1.1	全阻抗值 (Total Resistance)	1K $\Omega$ ~ 2M $\Omega$			
1.2	全阻抗值允许偏差 (Total Resistance Tolerance)	$\pm 20\%$ ( More than 1 M $\Omega$ $\pm 30\%$ )			
1.3	電阻隨溫度變化特性 Resistance of temperature change character)	20 $^{\circ}$ C -75 $^{\circ}$ C : $\Delta R/R \leq \pm 5\%$ , -25 $^{\circ}$ C -20 $^{\circ}$ C : $\Delta R/R \leq \pm 4.5\%$			
1.4	阻值變化特性 (Resistance Taper)	A, B , C, W			
1.5	零位阻值 (Residual Resistance)	R $\geq$ 250K $\Omega$ / 0.1 % max. of total Value 250K $\Omega$ >R>10K $\Omega$ / 20 $\Omega$ max. 10K $\Omega$ >R / 10 $\Omega$ max.			
1.6	額定功率 (Rated Power)	Linear Taper B: 0.05W Other Taper:0.025W			
1.7	最高使用電壓 (Max.Operating Voltage)	50V AC; 20V DC			
1.8	動雜音 (Rotational Noise)	Less Than 100mV			
1.9	絕緣阻抗 (Insulation Resistance)	More than 100M $\Omega$ at DC 250V			
1.10	耐電壓 (Withstand Voltage)	For 1 minute at: AC 500V			
1.11	开关额定功率(Switch Rated Power)	-----			
1.12	同步誤差 (Gang Error)	-----			
2.機械性能 (Mechanical Characteristics)					
2.1	全回轉角度 (Rotation Angle)	300 $^{\circ}$ $\pm$ 10 $^{\circ}$			
2.2	旋轉力矩 (Rotation Torque)	20~200gf.cm			
2.3	軸的拉、押強度 (Pull-Push Strength)	4 Kgf.cm			
2.4	轉動止檔強度 (Rotational Stop-End Torque)	3 kgf.cm Min			
2.5	开关角度(Switch Working Angel)	-----			
2.6	开关力矩(Switch Working Torque)	-----			
2.7	旋轉定位數目 (Number of Detents(click))	detent: 0 ; 1 centre Click			
2.8	焊錫耐熱性 (Resistance To Soldering Heat)	260 $\pm$ 5 $^{\circ}$ C and less than 3 seconds			
3.耐久性能 (Durability)					
3.1	回轉壽命 (Rotation Life)	10,000 Cycles min.			
3.2	工作溫度 (Operating temperature)	-10 $^{\circ}$ C ~+70 $^{\circ}$ C			
4.1	外形尺寸圖/曲線特性圖 (Shape size drawing/curve characteristic drawing)	見附頁 Please refer the drawing			
批 准		審 核		設 計	

# RESISTANCE TAPER

TAPER B SERIES

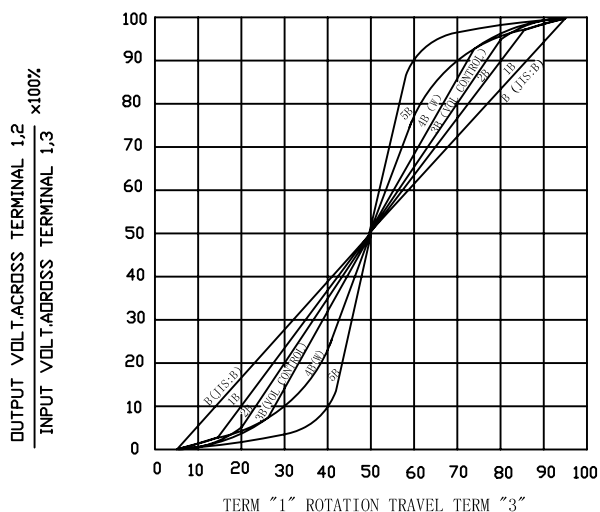

TAPER B WITH 50% TAP

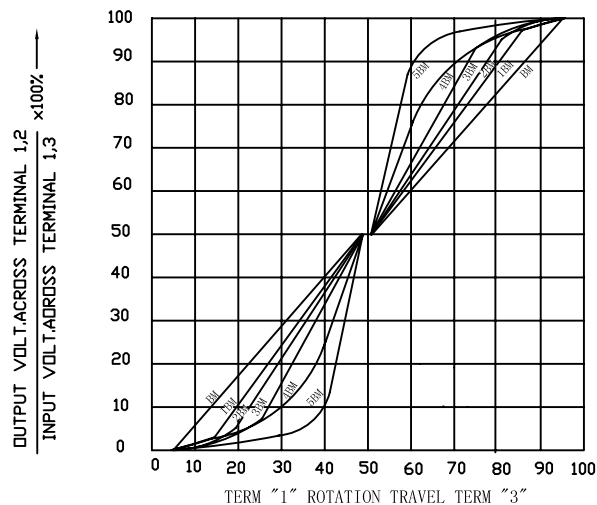

TAPER A SERIES

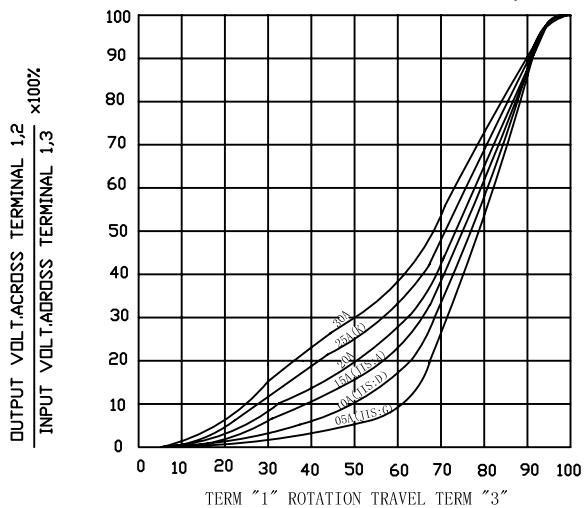

TAPER A & C WITH 50% TAP

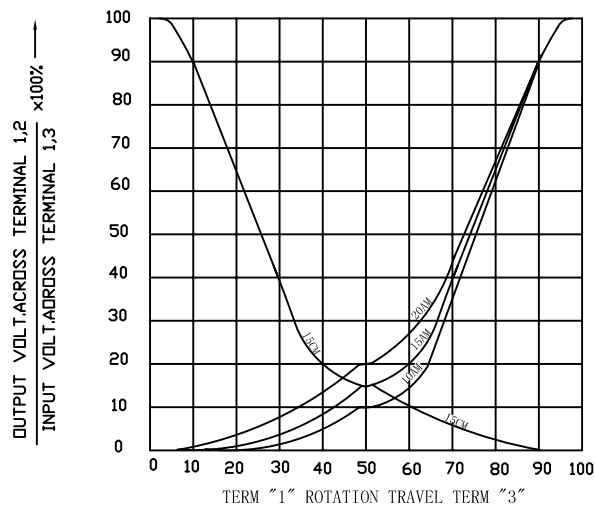

TAPER C SERIES

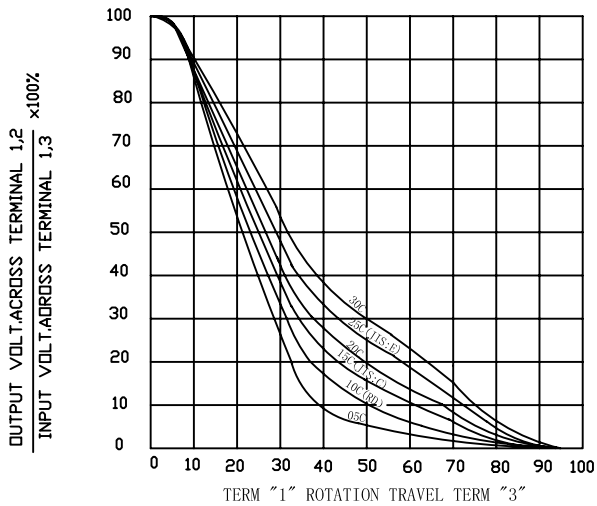

TAPER M & N SERIES

