

外形图 Mechanical Dimensions

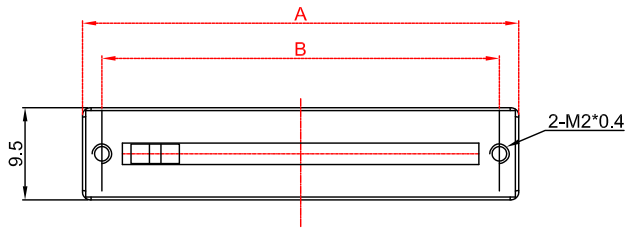

接线图
Circuit explanation

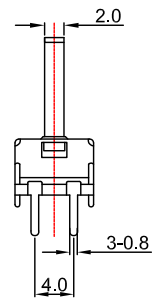
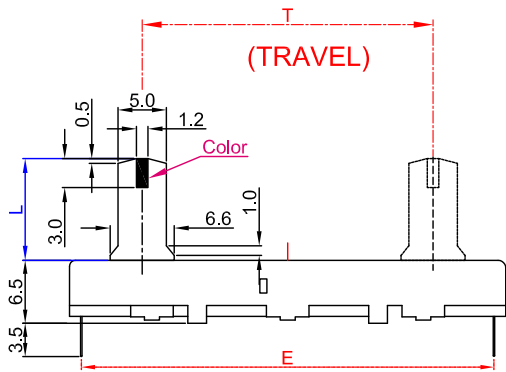
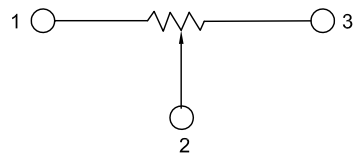

安装孔位图
P.C.B. mounting hole detail

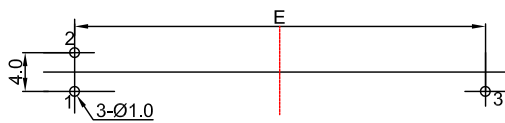

Color(颜色)	
R(red红色)	W(white白色)



H型塑胶推柄 (Insulated Lever)

	<input type="checkbox"/>	<input type="checkbox"/>	<input type="checkbox"/>	<input type="checkbox"/>	<input type="checkbox"/>	<input type="checkbox"/>
X	8	7	9			
L	10	15	20			

MODEL NO.	T	A	B	E
<input type="checkbox"/> C1531N	15	30	26	28.5
<input type="checkbox"/> C2031N	20	35	31	33.5
<input type="checkbox"/> C3031N	30	45	41	43.5
<input type="checkbox"/> C4531N	45	60	56	58.5

3			PRODUCT NAME	Slide Potentiometer		
2			MODEL NAME	C <input type="checkbox"/> <input type="checkbox"/> 31N - <input type="checkbox"/> A <input type="checkbox"/> 1-value		
1						
NO	DATE	DESCRIPTION	APPROVED BY	CHECKED BY	DRAWN BY	
			R & D 2015/2/6 Eva	R & D 2015/2/6 Sophie	R & D 2015/2/6 Ball	
DIMENSION	TOLERANCE	SCALE				
$\int \leq 10$	± 0.2	UNIT	mm			
$10 < \int \leq 30$	± 0.5	VER.	A0			
$30 < \int \leq 100$	± 1.0	DATE	2014/08/21			
All Angles	$\pm 5^\circ$					

Slide Potentiometers series Specifications

1. 電氣性能 (Electrical Characteristics)					
1.1	全阻抗值 (Total Resistance)	1KΩ ~ 2MΩ			
1.2	全阻抗值允許偏差 (Total Resistance Tolerance)	±20% (More than 1 M Ω ±30%)			
1.3	電阻隨溫度變化特性 Resistance of temperature change character)	20℃-75℃:ΔR/R≤±5%, -25℃-20℃:ΔR/R≤±4.5%			
1.4	阻值變化特性 (Resistance Taper)	A, B, C, W			
1.5	零位阻值 (Residual Resistance)	R>250KΩ / 0.1 % max. of total Value 250KΩ>R>10KΩ / 20Ω max. 10KΩ>R / 10Ω max.			
1.6	額定功率 (Rated Power)	Linear Taper B: 0.1W Other Taper:0.05W			
1.7	最高使用電壓 (Max.Operating Voltage)	100V AC			
1.8	動雜音 (Rotational Noise)	Less Than 100mV			
1.9	絕緣阻抗 (Insulation Resistance)	More than 100MΩ at DC 200V			
1.10	耐電壓 (Withstand Voltage)	For 1 minute at: AC 100V			
1.11	開關額定功率(Switch Rated Power)	-----			
1.12	同步誤差 (Gang Error)	-----			
2. 機械性能 (Mechanical Characteristics)					
2.1	滑動行程 (Slide travel)	T=(15,20,30,45,60)±1.0mm			
2.2	滑動力矩 (Operating force)	10~200gf.cm			
2.3	柄的拉、押強度 (Pull-Push Strength)	3 Kgf.cm			
2.4	滑動止檔強度 (Rotational Stop-End Torque)	2 kgf.cm Min			
2.5	開關角度(Switch Working Angel)	-----			
2.6	開關力矩(Switch Working Torque)	-----			
2.7	旋轉定位數目 (Number of Detents(click))	detent: 0 or 1centre click			
2.8	焊錫耐熱性 (Resistance To Soldering Heat)	<u>260±5</u> ℃ and less than <u>3</u> seconds			
3. 耐久性能 (Durability)					
3.1	回轉壽命 (Rotation Life)	10,000 Cycles min.			
3.2	工作溫度 (Operating temperature)	-10℃~+70℃			
4.1	外形尺寸圖/曲線特性圖 (Shape size drawing/curve characteristic drawing)	見附頁 Please refer the drawing			
批 准		審 核		設 計	

RESISTANCE TAPER

TAPER B SERIES

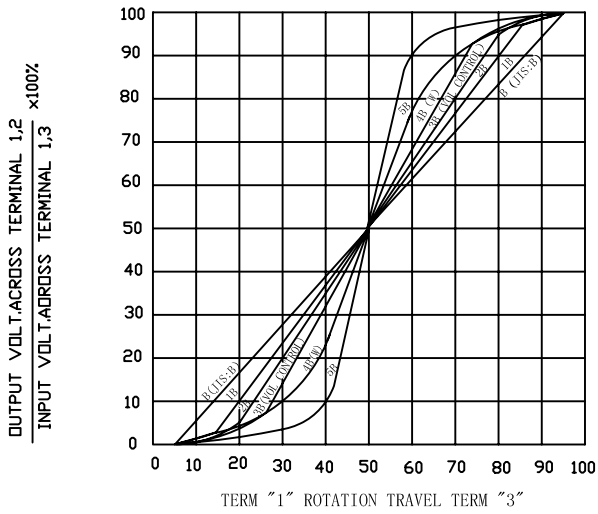

TAPER B WITH 50% TAP

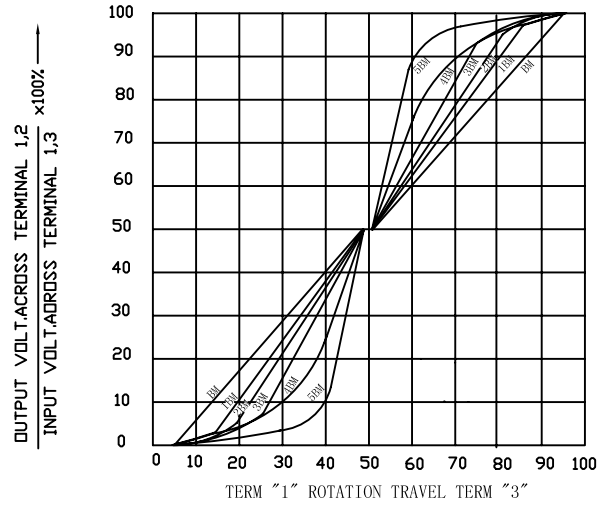

TAPER A SERIES

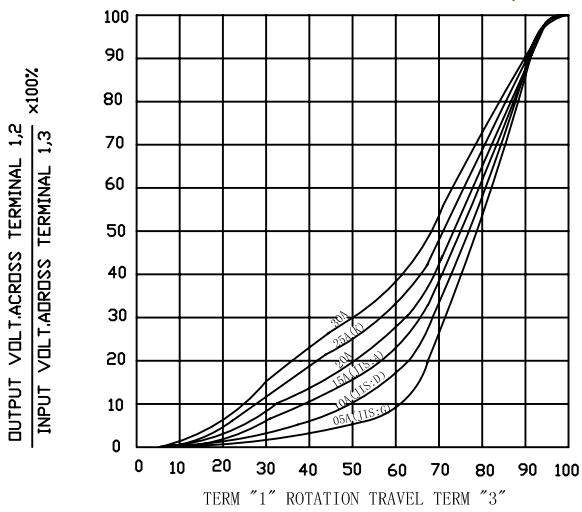

TAPER A & C WITH 50% TAP

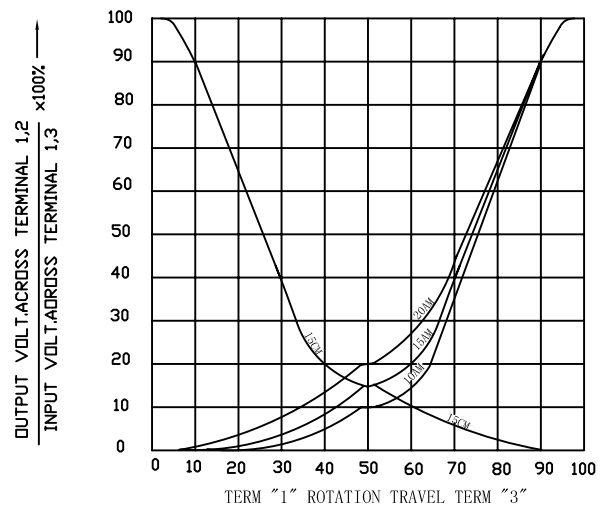

TAPER C SERIES

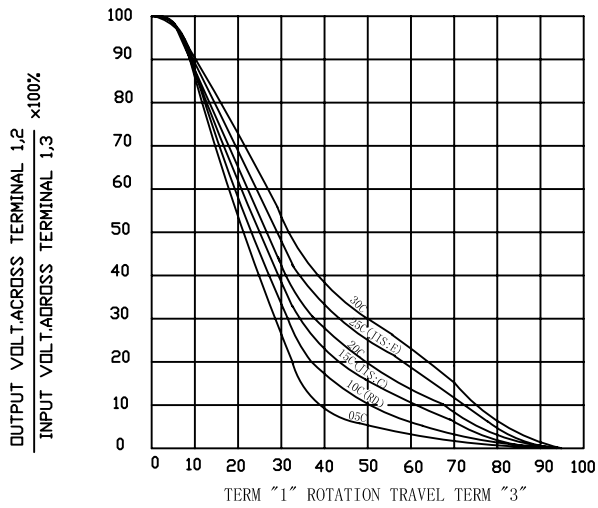

TAPER M & N SERIES

