

一、直滑式電位器系列技術規格書

Slide Potentiometers Technic Specifications

| 1. 電氣性能 (Electrical Characteristic) | | | | | |
|---|---|--------|---|---|---|
| 序号 | 項目 | | | 特性 | |
| 1.1 | 全阻抗值 (Total Resistance) | | | 1KΩ ~ 2MΩ | |
| 1.2 | 全阻抗值允許偏差 (Total Resistance Tolerance) | | | ± 20% | |
| 1.3 | 電阻隨溫度變化特性 (Resistance of temperature change character) | | | 20℃~75℃: $\Delta R/R \leq \pm 5\%$, -25℃~20℃: $\Delta R/R \leq \pm 4.5\%$ | |
| 1.4 | 阻值變化特性 (Resistance Taper) | | | A, B, C | |
| 1.5 | 零位阻值 (Residual Resistance) | | | Term 1~2: Less than 20Ω ; Term 2~3: Less than 20Ω | |
| 1.6 | 額定功率 (Rated Power) | | | Carbon Film Type 0.05W | |
| 1.7 | 最高使用電壓 (Max. Operating Voltage) | | | AC 100V | |
| 1.8 | 動雜音 (Rotational Noise) | | | Less than 100mV | |
| 1.9 | 絕緣阻抗 (Insulation Resistance) | | | 100MΩ at AC 250V | |
| 1.10 | 耐電壓 (With Stand Voltage) | | | 1 minute at: AC 300V | |
| 1.11 | 同步誤差 (Gang Error) | | | 0dB ~ -40dB ≤ 3dB | |
| 2. 機械性能 (Mechanical Characteristics) | | | | | |
| 2.1 | 滑動力矩 (Operating Force) | | | 20~200gf.cm | |
| 2.2 | 滑動行程 (Slide travel) | | | T ± 1.0mm | |
| 2.3 | 定位點位置 (Click Position) | | | <input type="checkbox"/> Center click | |
| 2.4 | 止檔強度 (Stop-End Torque) | | | 3kgf.cm.min | |
| 2.5 | 焊錫耐熱性 (Resistance To Soldering Heat) | | | 260 ± 5℃ and less than 3 seconds | |
| 3. 耐久性能 (Durability) | | | | | |
| 3.1 | 使用溫度 (Operating temperature range) | | | -10℃ ~ +70℃ | |
| 3.1 | 滑動壽命 (Sliding Life) | | | 10,000 Cycles | |
| 4. 外形尺寸圖 / 曲線特性圖 (Shape size drawing / curve characteristic drawing) | | | | 見附頁 (Please see attachment) | |
| 5 | | | | | |
| 批 准 | | 審 核 |  | 設 計 |  |

外形圖 Mechanical Dimensions

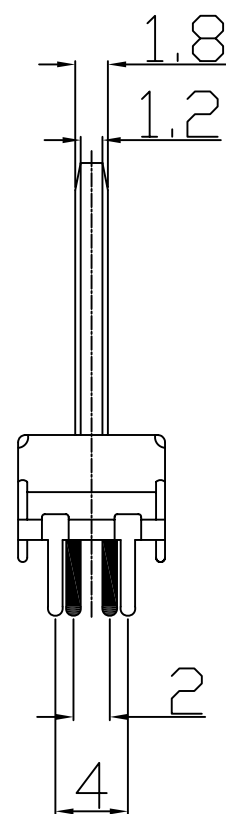
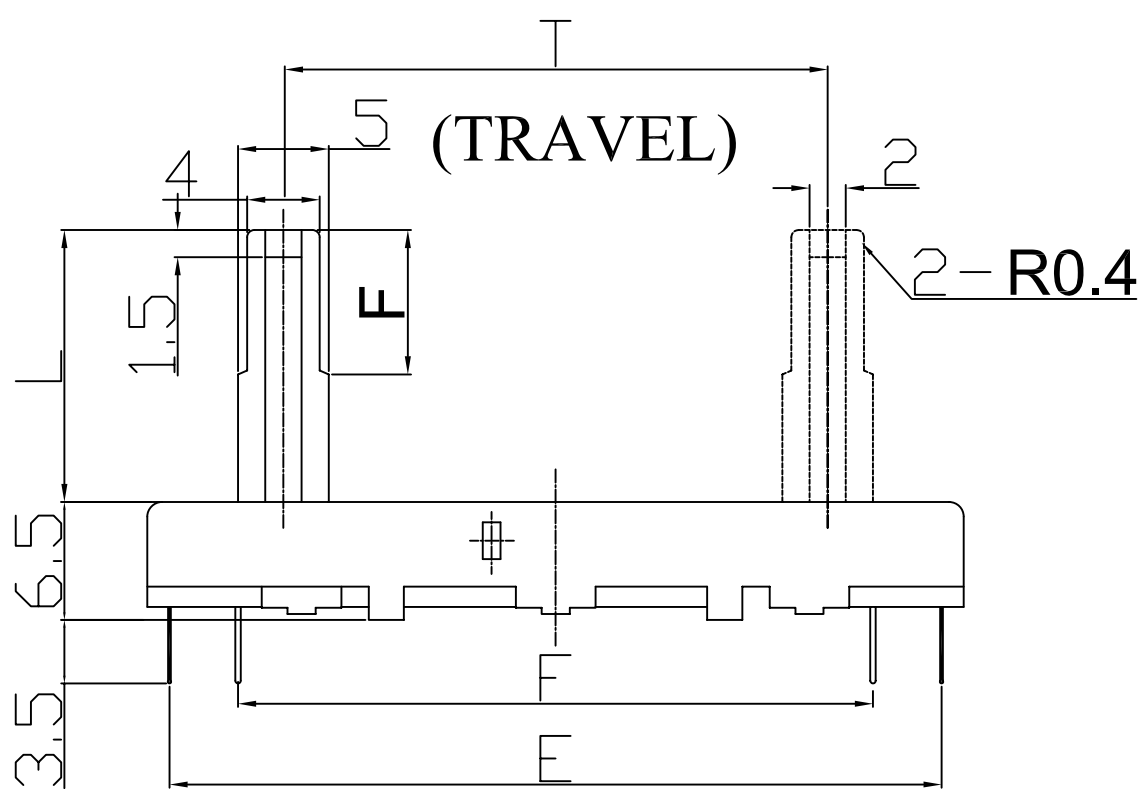
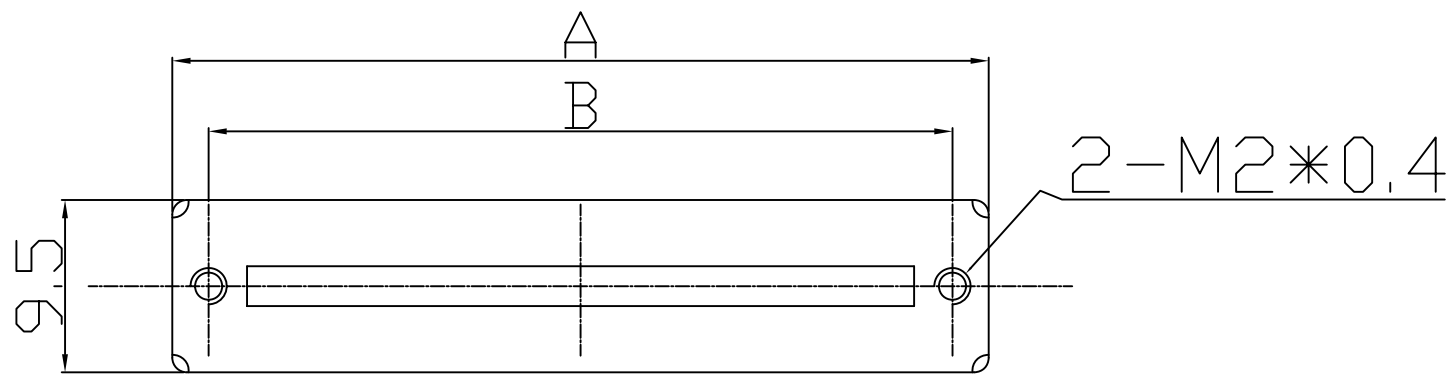

安裝孔位置圖
Mounting Hole

接線圖
Circuit Explanation

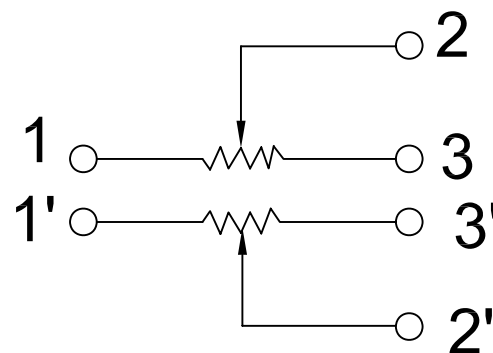
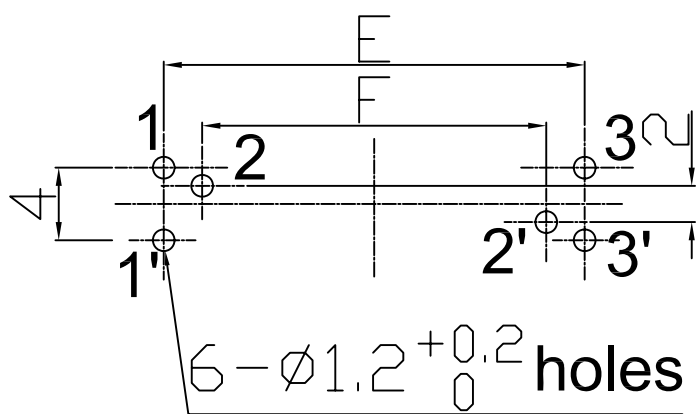

| | | | | | | | | |
|----|-----|----|------|----|----|----|----|--|
| X | 0 | 1 | 2 | 3 | 5 | 6 | 7 | |
| L | 8.5 | 10 | 12.5 | 15 | 18 | 20 | 25 | |
| F1 | 3.5 | 5 | 5 | 5 | 5 | 5 | 5 | |

| | | | | | |
|---------|----|----|----|------|------|
| T=□□ | T | A | B | E | F |
| □ C1531 | 15 | 30 | 26 | 28.5 | 18.0 |
| □ C2031 | 20 | 35 | 31 | 33.5 | 23.0 |
| □ C3031 | 30 | 45 | 41 | 43.5 | 33.0 |
| □ C4531 | 45 | 60 | 56 | 58.5 | 48.0 |

| | | | | | |
|----|------|-------------------|--------------|---|------------|
| 3 | | | PRODUCT NAME | Slide Potentiometers(with case) | |
| 2 | | | MODEL NAME | □□ _T 31G-□ _X A1-Value | |
| 1 | | | | | |
| NO | DATE | DESCRIPTION | APPROVED BY | CHECKED BY | DRAWN BY |
| | | DIMENSION | TOLERANCE | SCALE | |
| | | $l \leq 10$ | ± 0.2 | UNIT | mm |
| | | $10 < l \leq 30$ | ± 0.5 | VER. | |
| | | $30 < l \leq 100$ | ± 1.0 | DATE | 2007/08/09 |

R & D
 2010.12.03
 Sam

R & D
 2010.12.03
 Sam



YU WAH (S Z) CO., LTD

RESISTANCE TAPER

TAPER B SERIES

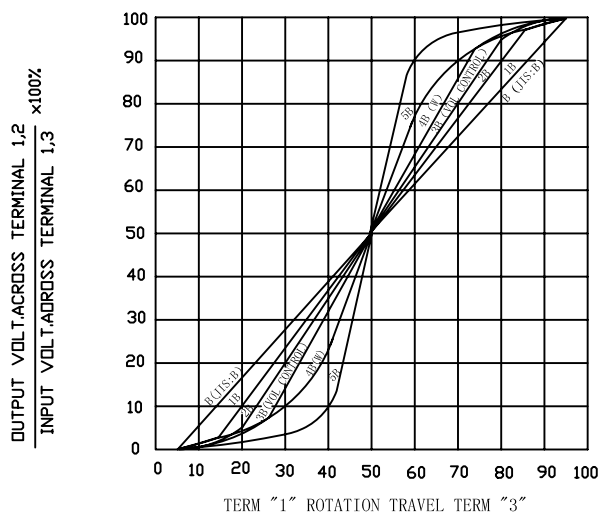

TAPER B WITH 50% TAP

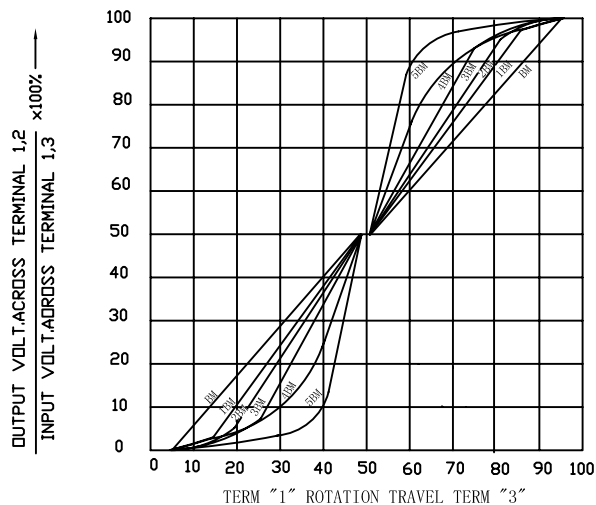

TAPER A SERIES

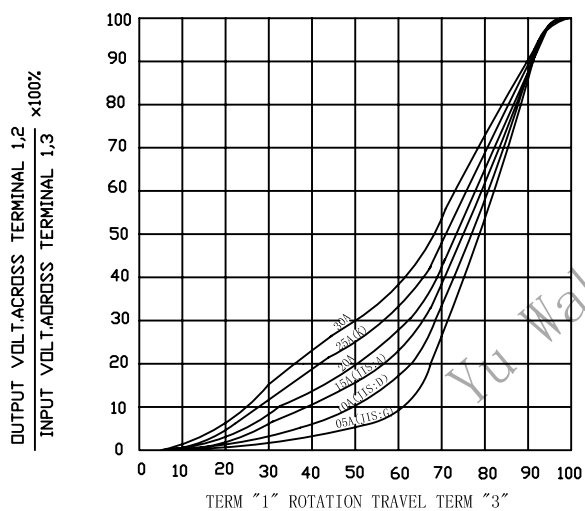

TAPER A & C WITH 50% TAP

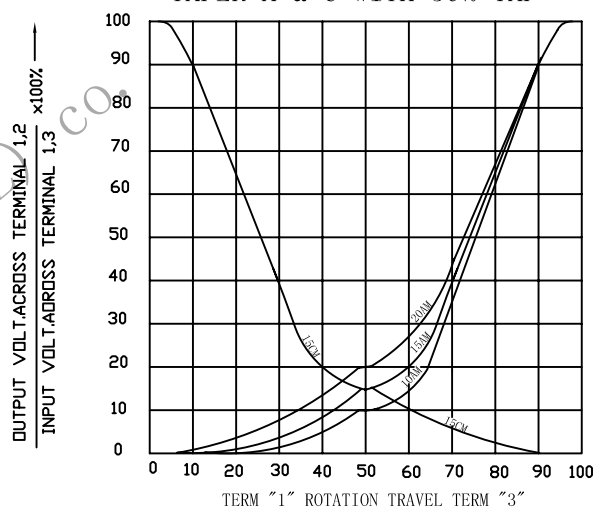

TAPER C SERIES

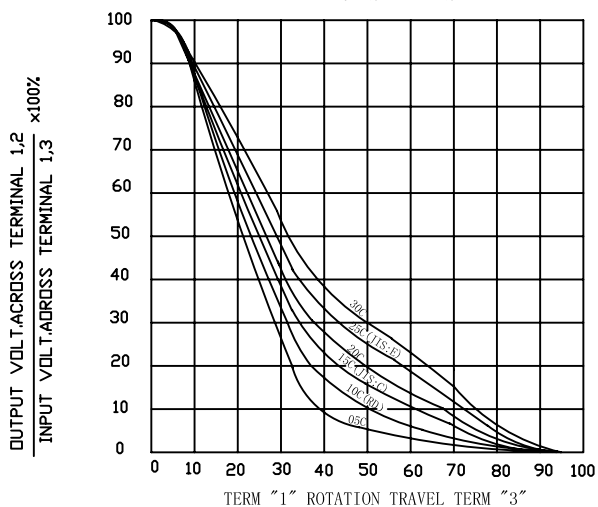

TAPER M & N SERIES

